

Shift Cable

Removal/Installation

SRS wire harness is routed near the shift lever.

CAUTION:

- All SRS wiring harnesses are covered with yellow outer insulation.
- Before disconnecting any part of the SRS wire harness, install the short connectors (see [section 23](#)).
- Replace the entire affected SRS harness assembly if it has an open circuit or damaged wiring.

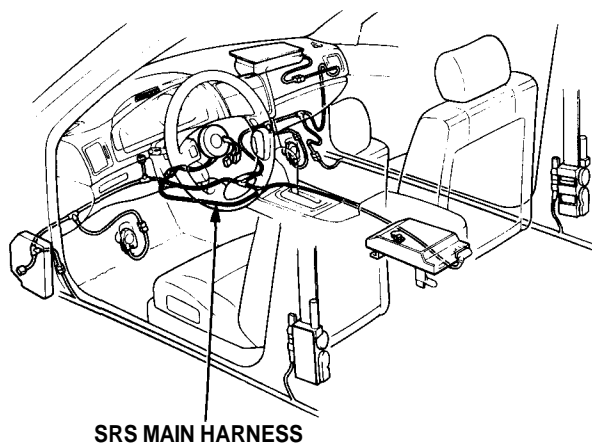

⚠ WARNING

- Make sure lifts, jacks and safety stands are placed properly (see [section 1](#)).
- Apply parking brake and block rear wheels, so the car will not roll off stands and fall while you are working under it.

1. Remove the center console (see [section 20](#)).
2. Shift to **R** position, then remove the lock pin from the cable adjuster.

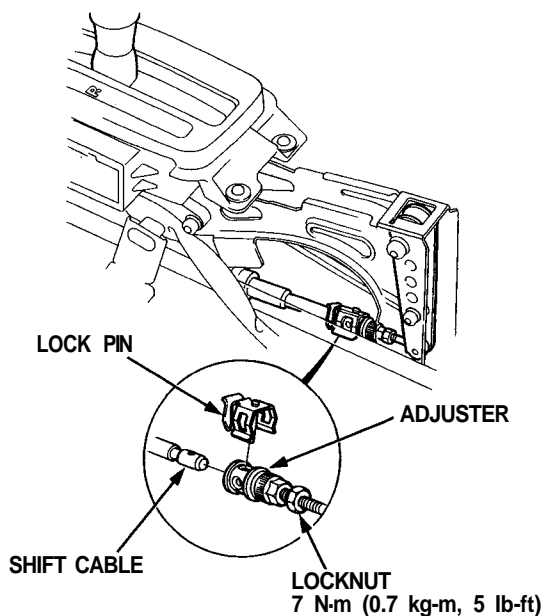

3. Remove the three-way catalytic converter.

4. Remove the exhaust pipe A.

NOTE: All the nut show below are all self-locking, and therefore should be replace.

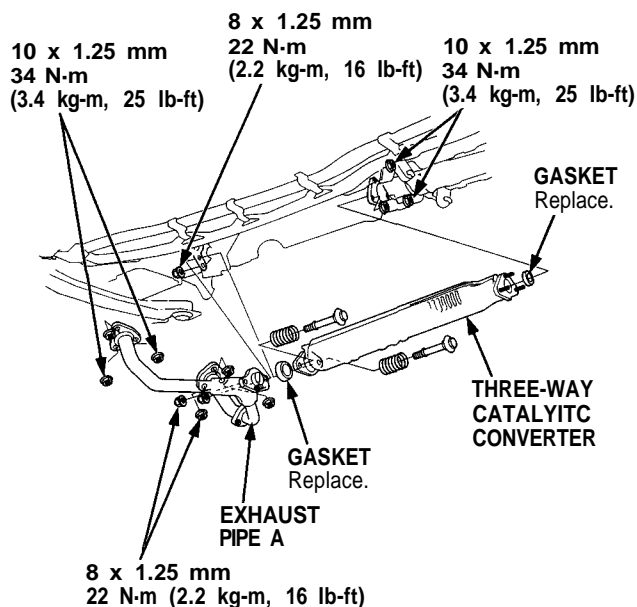

5. Remove the heat shields.

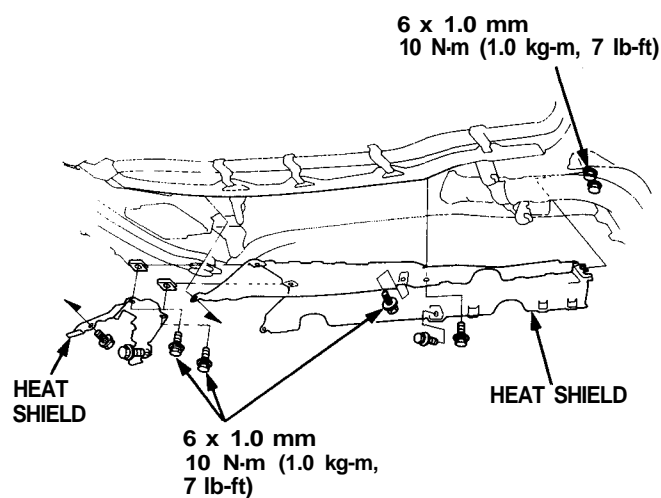



6. Remove the shift cable bracket.

CAUTION: Take care not to bend the cable when removing/installing it.

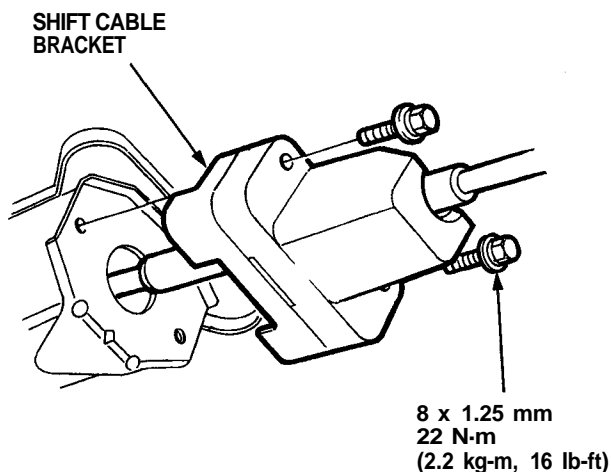

7. Remove the shift cable guide from the transmission beam.

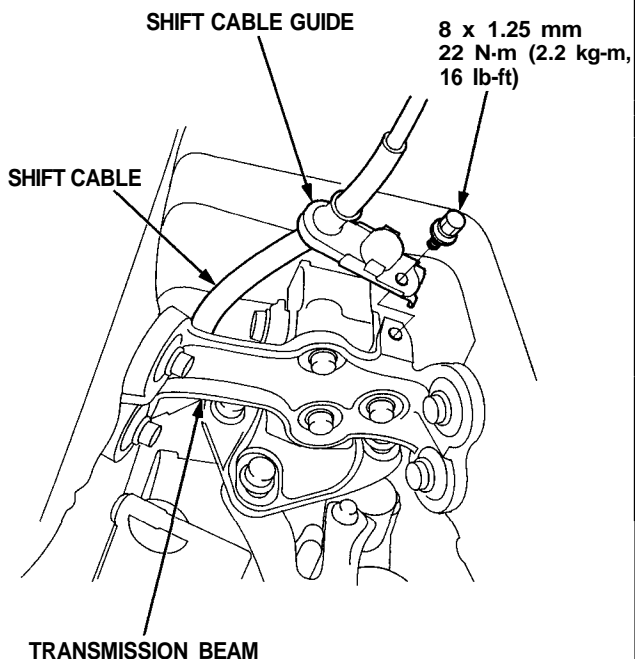

8. Remove the shift cable cover.

9. Remove the shift cable holder from the shift cable holder base and from the shift cable.

10. Remove the control lever from the control shaft.

11. Remove the shift cable.

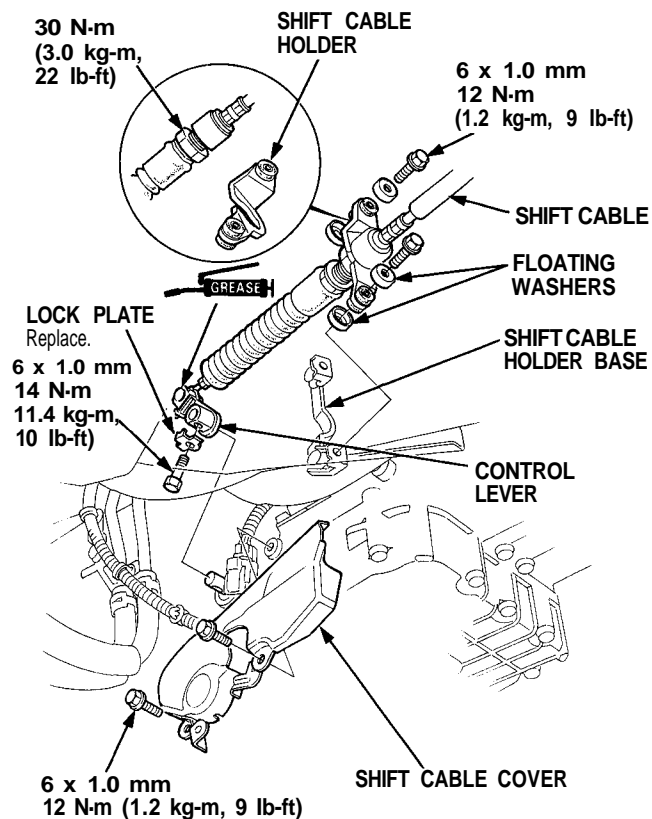

12. Install the shift cable in the reverse order of removal.

13. Check the cable adjustment on reassembly (see page [14-172](#)).